

かほく市外日角壱号

S=1:250

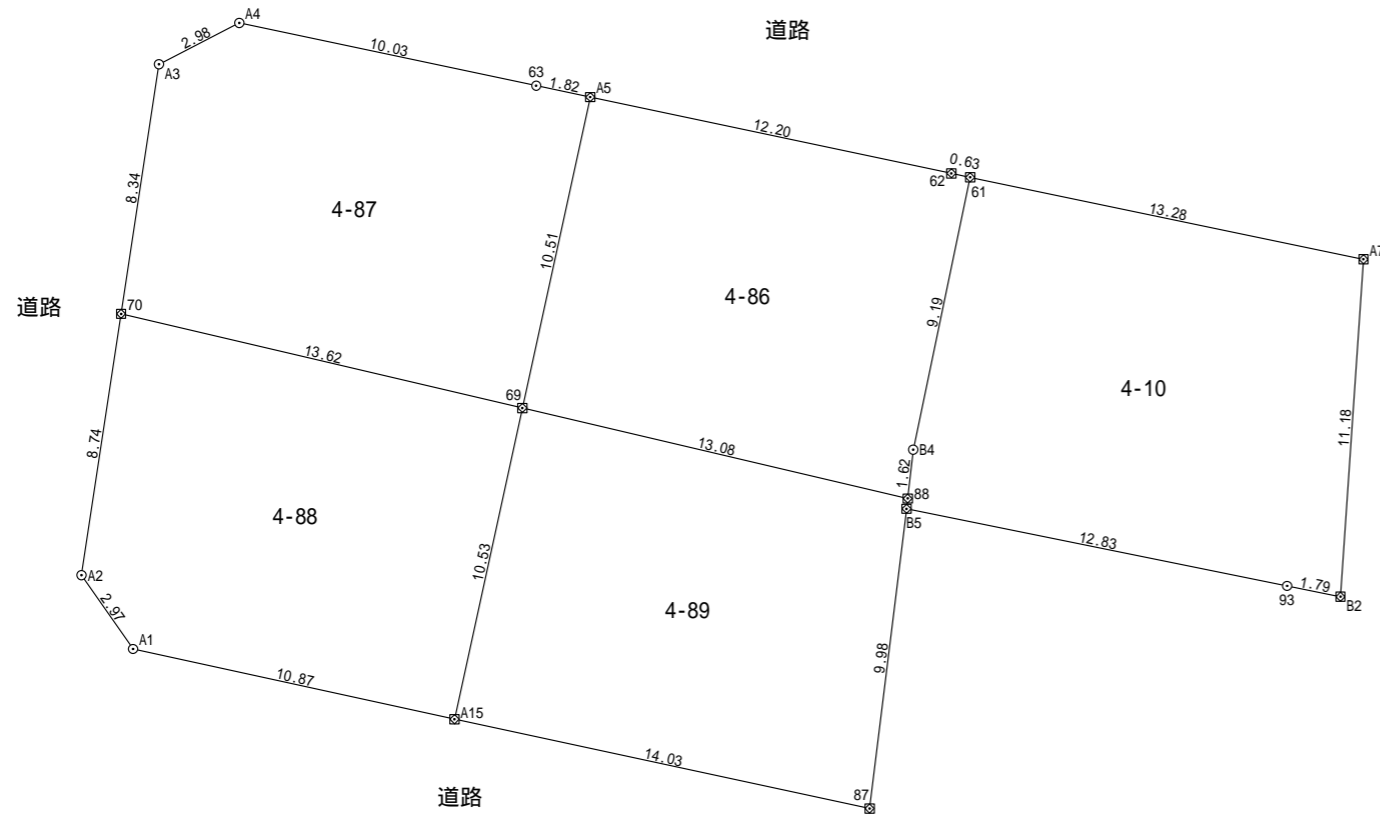
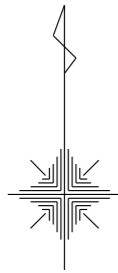

境界標の種類

	境界標識板
	ペンキ

地番	4-10		
測点	Xn	Yn	(Xn+1 - Xn-1)Yn
A7	91.335	139.650	1936.247250
61	94.044	126.649	-797.382104
B4	85.039	124.768	-1324.661856
88	83.427	124.583	-243.061433
B5	83.088	124.544	-359.932160
93	80.537	137.126	-398.899534
B2	80.179	138.890	1499.734220
		倍面積	312.044383
		面積	156.0221915
		地積	156.02 m ²

地番	4-86		
測点	Xn	Yn	(Xn+1 - Xn-1)Yn
61	94.044	126.649	1157.191913
62	94.176	126.028	334.226256
A5	96.696	114.088	-885.094704
69	86.418	111.846	-1484.084574
88	83.427	124.583	-171.799957
B4	85.039	124.768	1324.661856
		倍面積	275.100790
		面積	137.5503950
		地積	137.55 m ²

地番	4-87		
測点	Xn	Yn	(Xn+1 - Xn-1)Yn
A5	96.696	114.088	1215.607640
63	97.073	112.302	275.139900
A4	99.146	102.487	72.355822
A3	97.779	99.828	-959.646564
70	89.533	98.578	-1119.944658
69	86.418	111.846	801.152898
		倍面積	284.665038
		面積	142.3325190
		地積	142.33 m ²

地番	4-88		
測点	Xn	Yn	(Xn+1 - Xn-1)Yn
70	89.533	98.578	-544.840606
A2	80.891	97.267	-1077.815627
A1	78.452	98.974	-471.215214
A15	76.130	109.601	873.081566
69	86.418	111.846	1499.071938
		倍面積	278.282057
		面積	139.1410285
		地積	139.14 m ²

地番	4-89		
測点	Xn	Yn	(Xn+1 - Xn-1)Yn
A15	76.130	109.601	-1451.226841
87	73.177	123.326	858.102308
B5	83.088	124.544	1276.576000
88	83.427	124.583	414.861390
69	86.418	111.846	-816.140262
		倍面積	282.172595
		面積	141.0862975
		地積	141.08 m ²